

**Typical Section 4" thru 26" Flush Condition**

**Note:**  
Flush condition fire barrier utilized for corner applications.

**Notes:**

- 1.) Please refer to the installation guide for information on splices, terminations, transitions, and additional details concerning adjacent construction.
- 2.) Wall build out may be required to accommodate larger fire barrier systems installed with "inside opening" expansion joints. Contact WBA for proper design assistance.
- 3.) \* - Depth of Fire Barrier includes 1" setback at face of wall. Setback can be adjusted for multiple styles of E.J. systems.
- 4.) Different brackets may be available for different site conditions. Contact WBA for assistance.

Fire Barrier To Be Installed With 18 Ga. Galv. Steel Cover (For Hidden Non-Accessible Areas). Or Engineered Expansion Control System (For Public Areas)

Dimensional Table		
Model (2 hr)	J.O.	Depth "A"*
VFG-202EE	2"	9"
VFG-402DD	4"	5"
VFG-602DD	6"	6"
VFG-802CC	8"	7 3/8"
VFG-1002	10"	12"
VFG-1202	12"	10 1/2"
VFG-1402KK	14"	13"
VFG-1602KK	16"	15"
VFG-1802KK	18"	17"
VFG-2002KK	20"	20"
VFG-2202KK	22"	19"
VFG-2402KK	24"	22"
VFG-2602KK	26"	22"

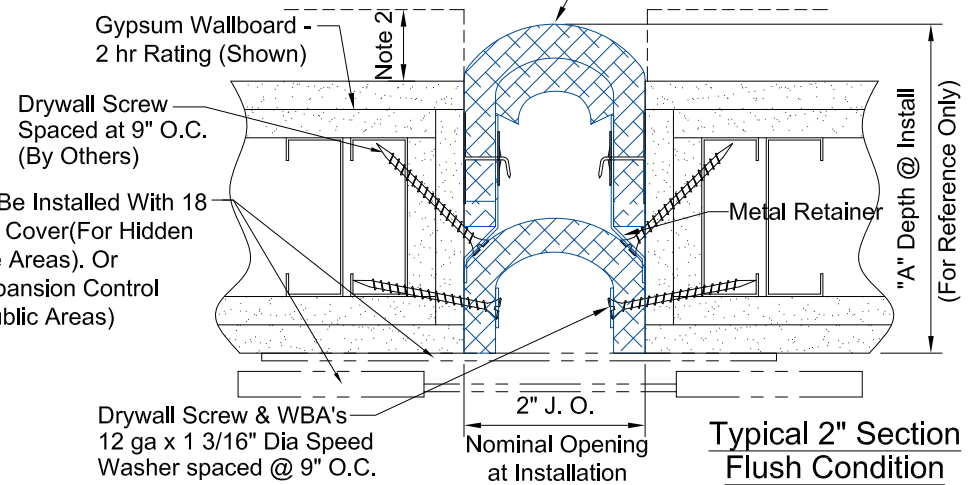
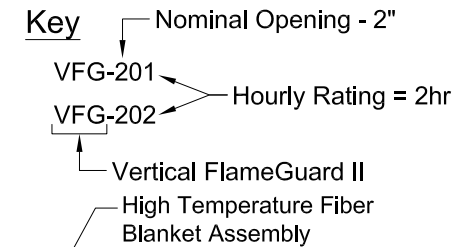

**Typical 2" Section Flush Condition**

PROJECT NAME: -

PROJECT LOCATION: -

DRAWING DESCRIPTION:  
**WaboFlameGuard**

DATE: 09/15/2017

MODEL: VFG



Watson Bowman Acme Corp.  
95 Pineview Drive Amherst, NY 14228  
phone: (716) 691-7566 fax: (716) 691-9239  
www.wbacorp.com



Information provided herein, including but not limited to, any drawing, design, photograph, graphic, or statement(s) ("Materials") are proprietary and the property of Watson Bowman Acme Corporation ("Company"). Reproduction, translation, or reduction to any electronic medium or machine readable form, in whole or part, is strictly prohibited, except for the express purpose for which it has been furnished, without prior written consent of Company. All Materials contained herein are provided by Company for information purposes only. Company reserves the right to amend or withdraw any information contained in the Materials without notice. All technical or other advice by Company, whether verbal or written, concerning products, or the use of products in specific situations ("Advice") is given by Company and is used at the Users own risk.

REVISION NO:  
1

SHEET NO:  
1

DRAWING NO:  
S-10006