

Retainers 'A-A'

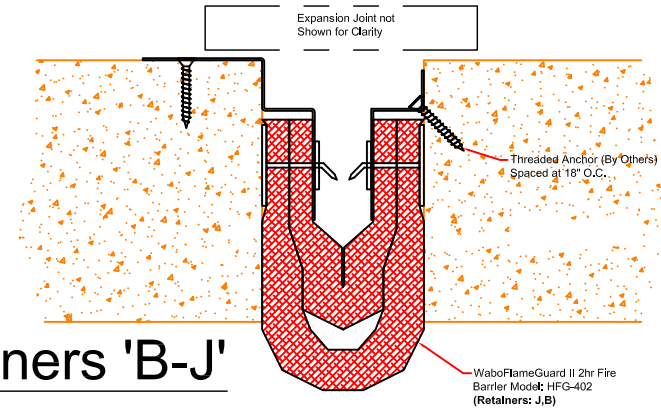

Retainers 'B-J'

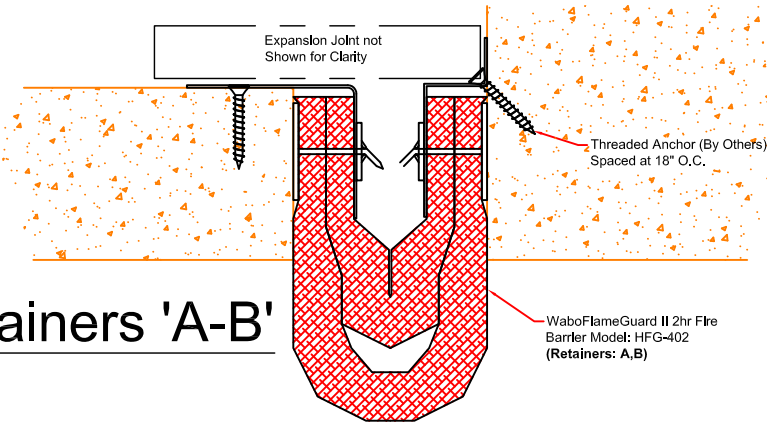

Retainers 'A-B'

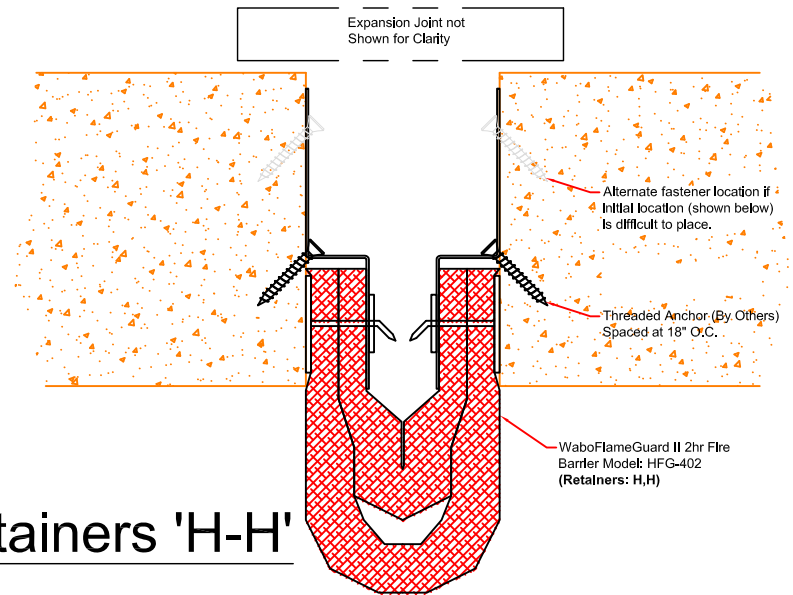

Retainers 'H-H'

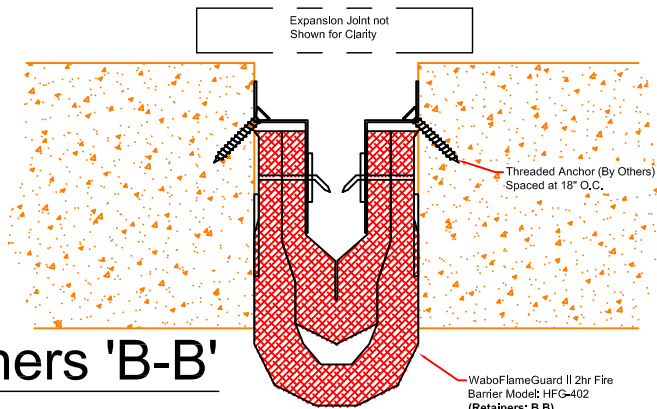

Retainers 'B-B'

Standard Series
Wabo®FlameGuard II Retainers
 HFG

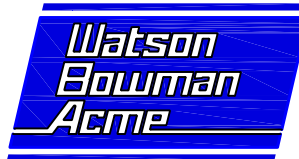

Watson Bowman Acme Corp.
 95 Phelev Drive Amherst, NY 14228
 phone: (716) 691-7566 fax: (716) 691-9239
www.wbacorp.com

Information provided herein, including but not limited to, any drawing, design, photograph, graphic, or statement(s) ("Materials") are proprietary and the property of Watson Bowman Acme Corporation ("Company"). Reproduction, translation, or reduction to any electronic medium or machine readable form, in whole or part, is strictly prohibited, except for the express purpose for which it has been furnished, without prior written consent of Company. All Materials contained herein are provided by Company for information purposes only. Company reserves the right to amend or withdraw any information contained in the Materials without notice. All technical or other advice by Company, whether verbal or written, concerning products, or the use of products in specific situations ("Advice") is given by Company and is used at the Users own risk.

DETAILED BY: JPK	DATE: 04/18/12
CHECKED BY: WBA	CURRENT ISSUE: 11/12/12
SHEET NO: 1	DRAWING NO: A - 29776

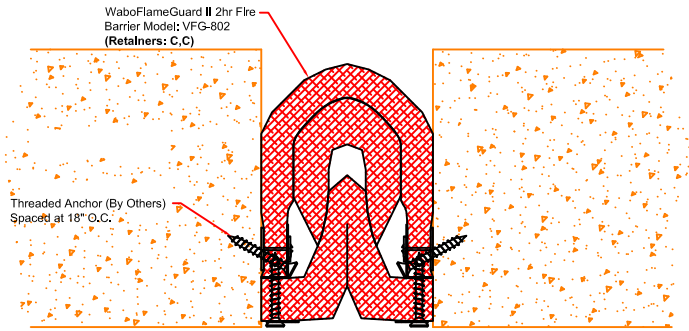

Retainers 'C-C'

Expansion Joint not
Shown for Clarity

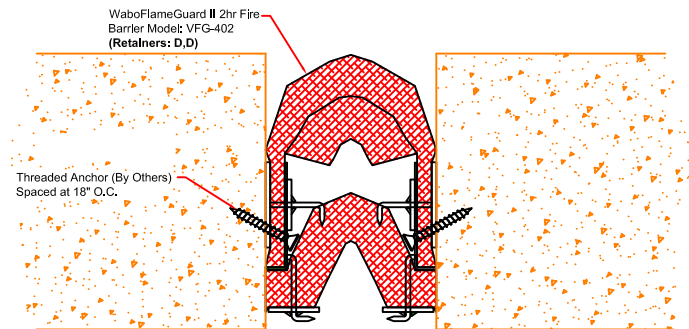

Retainers 'D-D'

Expansion Joint not
Shown for Clarity

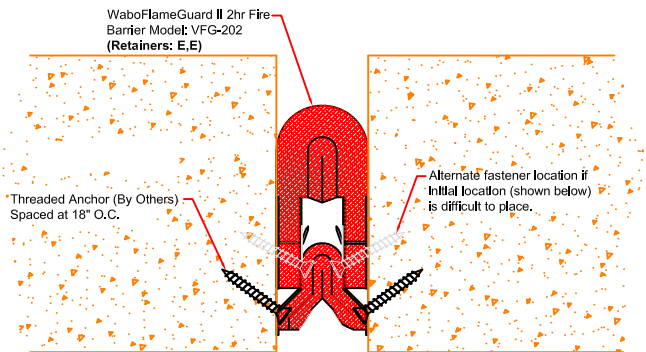

Retainers 'E-E'

Expansion Joint not
Shown for Clarity

WaboFlameGuard II 2hr Fire
Barrier Model: VFG-1402
(Retainers: K,K)

Threaded Anchor (By Others)
Spaced at 18" O.C.

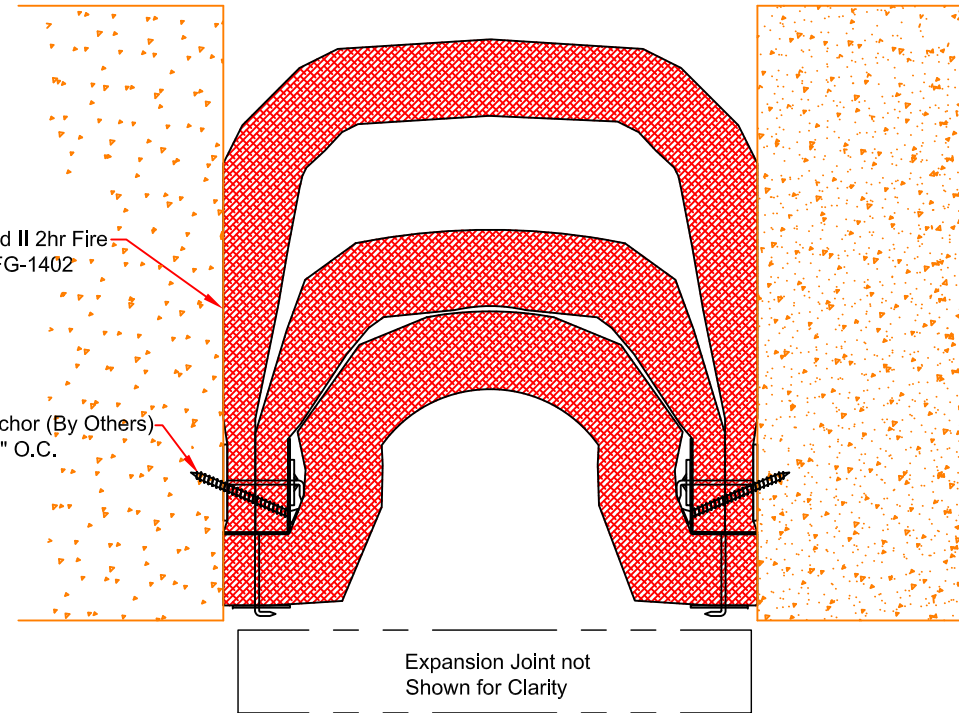

Expansion Joint not
Shown for Clarity

Retainers 'K-K'

Standard Series
Wabo®FlameGuard II Retainers
VFG

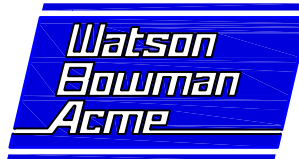

Watson Bowman Acme Corp.
95 Pheevlew Drive Amherst, NY 14228
phone: (716) 691-7566 fax: (716) 691-9239
www.wbacorp.com

Information provided herein, including but not limited to, any drawing, design, photograph, graphic, or statement(s) ("Materials") are proprietary and the property of Watson Bowman Acme Corporation ("Company"). Reproduction, translation, or reduction to any electronic medium or machine readable form, in whole or part, is strictly prohibited, except for the express purpose for which it has been furnished, without prior written consent of Company. All Materials contained herein are provided by Company for information purposes only. Company reserves the right to amend or withdraw any information contained in the Materials without notice. All technical or other advice by Company, whether verbal or written, concerning products, or the use of products in specific situations ("Advice") is given by Company and is used at the Users own risk.

DETAILED BY: JPK	DATE: 04/18/12
CHECKED BY: WBA	CURRENT ISSUE: 11/12/12
SHEET NO: 2	DRAWING NO: A - 29776